

Technology for Independent Living:

The Person-Centered Process from Technology Exploration to Implementation



Presented by: Emily Danciu-Grosso



*Simply*Home

- **A national enabling technology vendor committed to flexible, accessible, and consumer-centered supports that maximize independent living.**
- **Based in Asheville, NC.**
- **Our affiliated companies have been providing long-term care to the elderly and people with disabilities since 1989.**
- **Over 19 years of experience in creating and implementing technology.**
- **Multiple appearances on ABC's Extreme Makeover – Home Edition.**

Technology First



The latest and greatest gadgets and outfitting someone's home with technology just for the sake of using technology.

Technology First



Monitoring individuals and taking away their right to privacy and dignity of risk.

Technology First

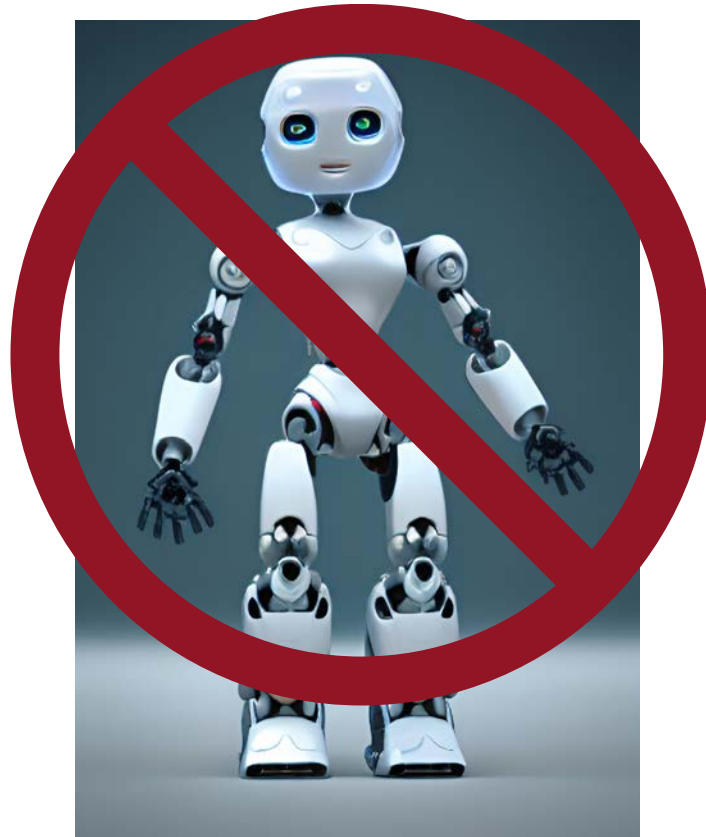

Replacing human.

Technology First

Least Invasive Natural Support.

- *a change in our thinking* about how we deliver services to individuals we support.

-first, think about the use of technology when considering all options for providing supports for individuals.

Benefits:

independence, dignity, safety, and freedom.

Technology= Accessibility



“For people without disabilities, technology makes things easier. For people with disabilities, technology makes things possible.”

- Mary Pat Radabaugh (IBM Training Module 1991).

Enabling Technology (ET) is the use of various forms of technology to support the independence of an individual in where they live, work, and play. Enabling Technology encompasses:

- Remote Supports and in-home sensors



- Assistive Technology

- Environmental Controls / Smart Home Technology

- Task prompting and sequencing



- Community navigation



Enabling Technology

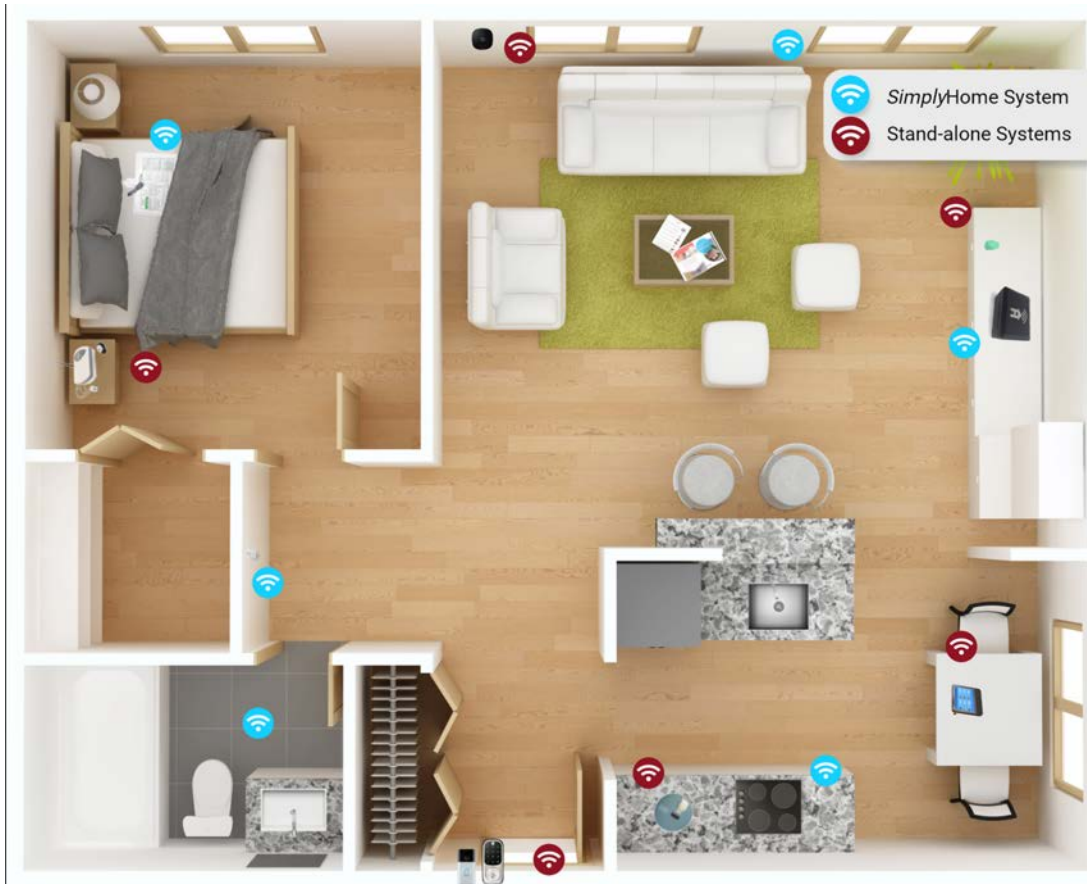

***Empower independence *Embody self-determination
*Enhance quality of life**

Remote Support

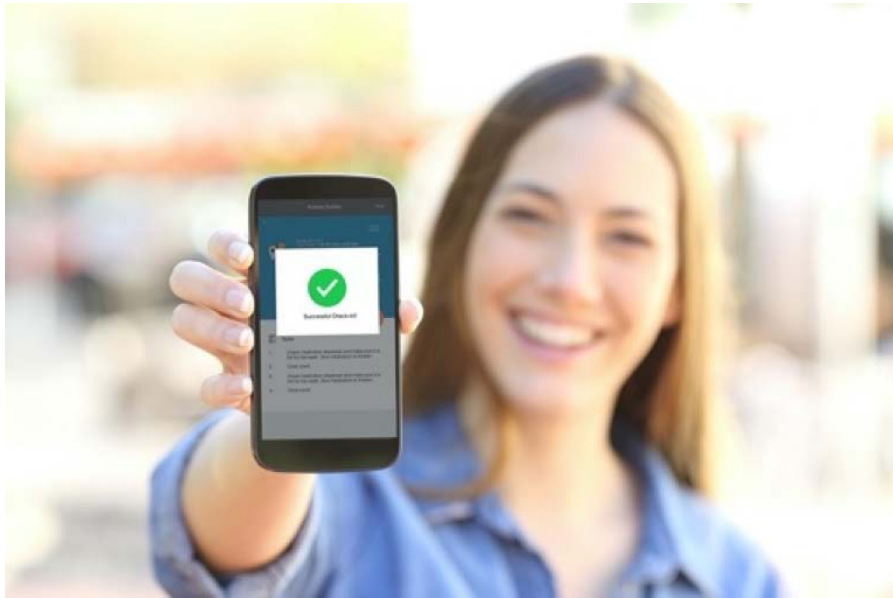

Direct support that is provided in a remote capacity in conjunction with or utilizing various forms of enabling technology.

**Best Practices in
implementing
technology into the
care model**

Best Practices

Organizational Preparedness = Success



- Form a Technology Committee/Team
- Identify a Tech Champion within the organization.

Technology Champions:

is an employee(s) designated to support the agency's technology initiatives and to design technology services for individuals utilizing enabling technologies and remote or virtual support.

Technology Champions:

A Technology Champion should receive external training and certification on technology-first principles.

Technology champions can be at any level within the organization, and their goal is to ensure that technology utilization is the first option for any identified need or outcome.

Technology champions will assist with:

- The identification of people supported
- Training & education throughout the agency
- Coordination of enabling technology implementation and support efforts.

A Technology Committee/Team:

It's important to identify the role and responsibilities of each member of the Technology Committee.



A Technology Committee will:

- Meet weekly, bi-weekly, or monthly
- Define the policies and procedures around enabling technology and remote support
- Develop the organization's technology-first plan

Best Practices

Stakeholder Buy-In



- Education, Education, Education
- Town Halls
- Demo Smart Home

Best Practices

Do Your Homework



- Learn from others
- Invest in consulting
- Operationally, what is realistic for your organization RIGHT now?

Best Practices

Always apply a Person-Centered Focus



"Nothing about me without ME."

Best Practices

Define your success



- What does success look like to the individual?
- What does success look like to the organization?

Best Practices

Be Flexible



- Be open to making changes, when changes are necessary.

Best Practices

Intentional Implementation



- Start with a single program or location

Best Practices

Celebrate your Outcomes

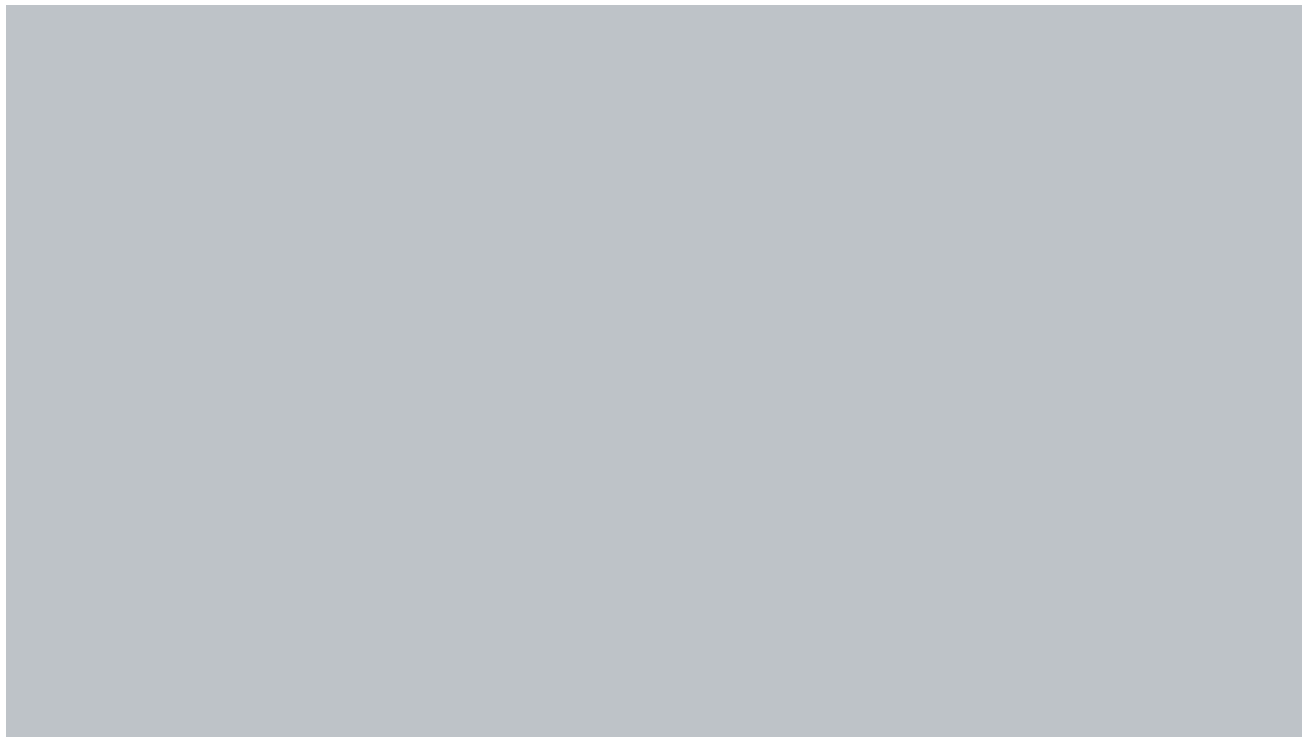

Review of best practices:

- Identify your tech champions
- Engage with stakeholders
- Do your homework: learn from others
- Apply a person-centered focus
- Define your success
- Be flexible
- Intentional Implementation
- Celebrate your outcomes



www.simply-home.com